



PLANS BY TOM BURY

# MURPHY WORKTABLE



TOTAL DIMENSIONS:  
FOLDED UP 30" X 48" X 0"  
FOLDED DOWN 30" X 58" X 84"

## MATERIALS LIST:

- |                                  |                              |
|----------------------------------|------------------------------|
| (2) 2"x8"x8'                     | (4) 2-7/8" headlok screws    |
| (3) 2"x4"x8'                     | 3-1/2" screws                |
| (1) 1"x2"x8'                     | 2-1/2" screws                |
| (1) 48"x96" 3/4" plywood         | 1-1/2" screws                |
| (2) 1-1/2"x30" continuous hinge  | 1-1/4" brad nails            |
| (1) Left-side lid support hinge  | Wood glue                    |
| (1) Right-side lid support hinge | Chalkboard paint, if desired |
| (1) 6" hook and eye latch        |                              |

## RECOMMENDED TOOLS:

- |                           |                           |
|---------------------------|---------------------------|
| Table saw or circular saw | Drill bit for pilot holes |
| Miter saw                 | Router                    |
| Drill/driver              | Rabbeting router bit      |
| 18 gauge brad nailer      |                           |

## LUMBER CUT LIST:

### 2X8X8'

45-1/2"	30"	
45-1/2"	30"	

### 2X4X8'

30"	30"	36"
30"	30"	36"
40"	40"	

### 1X2X8'

27"	27"	27"	
-----	-----	-----	--

## LUMBER CUT LIST:

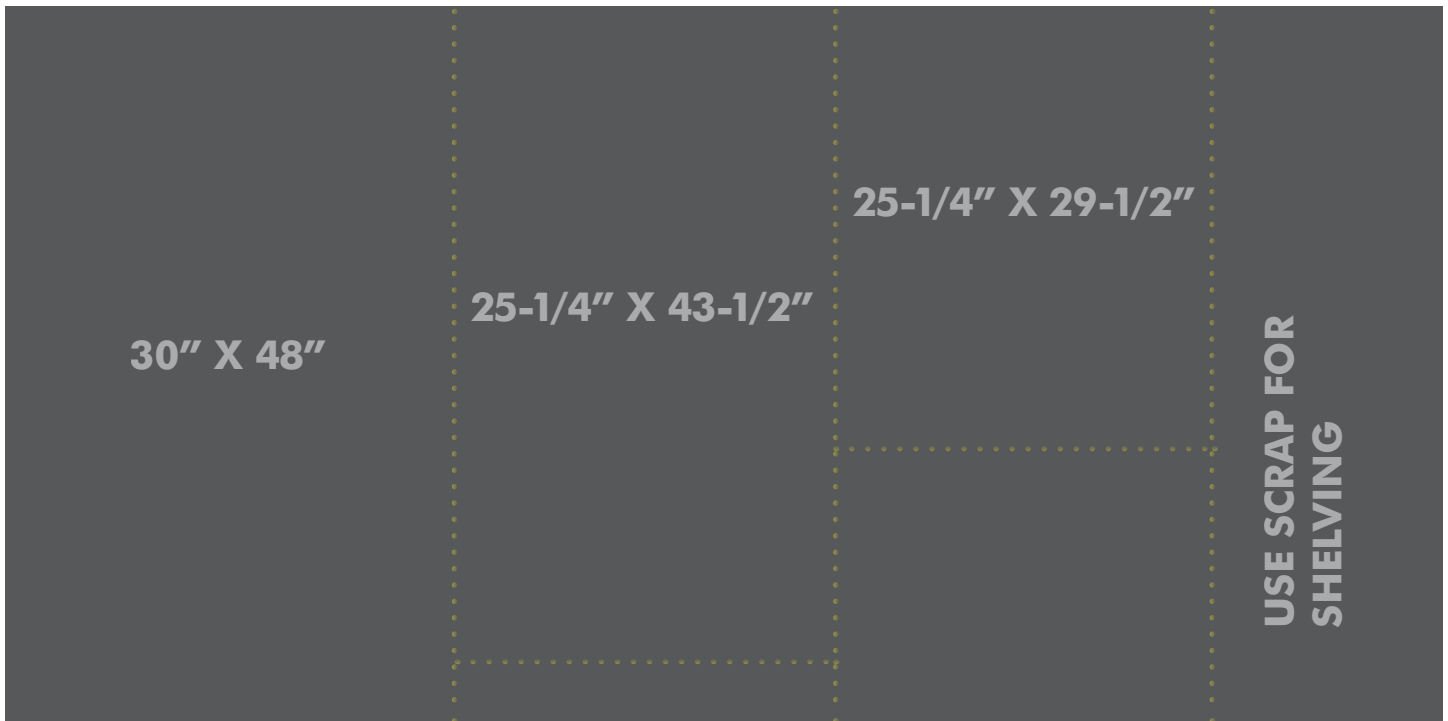

### HELPFUL HINT

Most The Home Depot stores will make complimentary plywood cuts.

# ASSEMBLY:

1

Start by constructing the sides of the cabinet.

Square off the edges of two 2x8s cut 45-1/2" long.

Next, make an angled cut so the top of each board starts at 3-1/4" deep then tapers down to the corner of the 2x8.



2

Next, from the remaining milled 2x8 material, cut a piece 30" long. Make an angled cut along the length of the board to match the angle and depth of the cabinet sides.

Drill pilot holes and attach top to cabinet sides with (4) 2-1/2" screws.

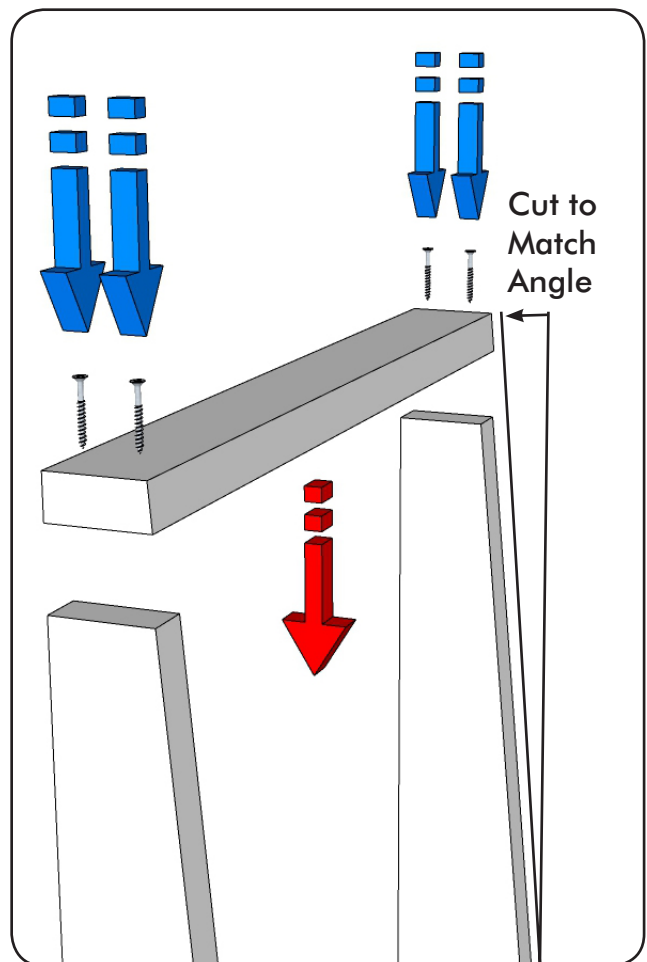

## ASSEMBLY:

**3**

To make the cabinet base, square off a 2x8 cut 30" long and attach with (4) 2-1/2" screws.

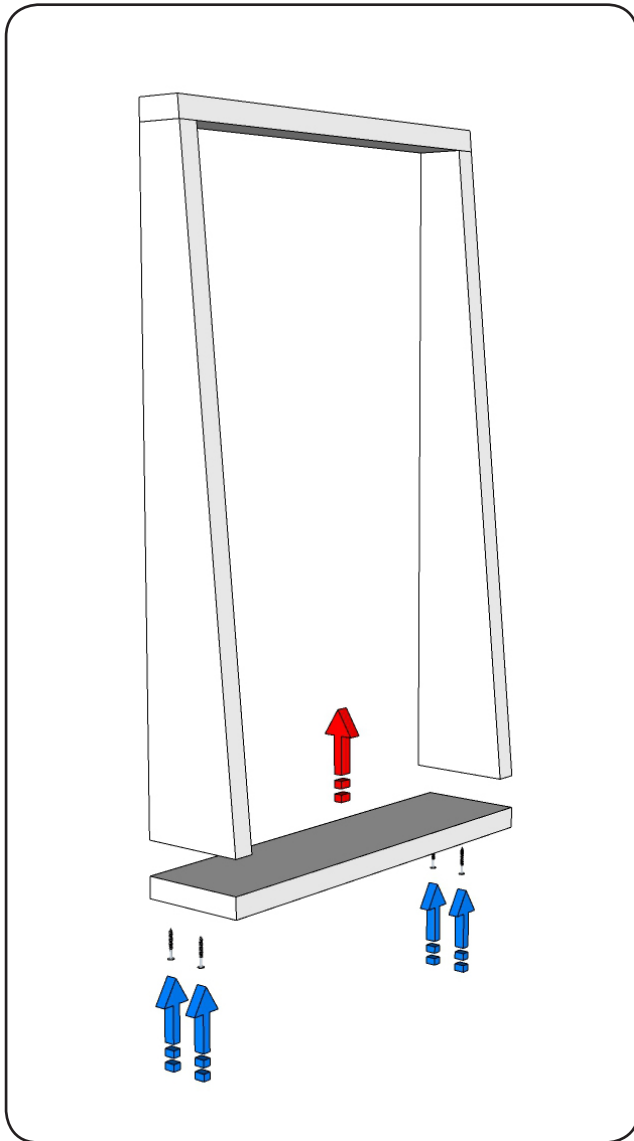

**4**

Attach back of cabinet with wood glue and 1-1/2" screws.

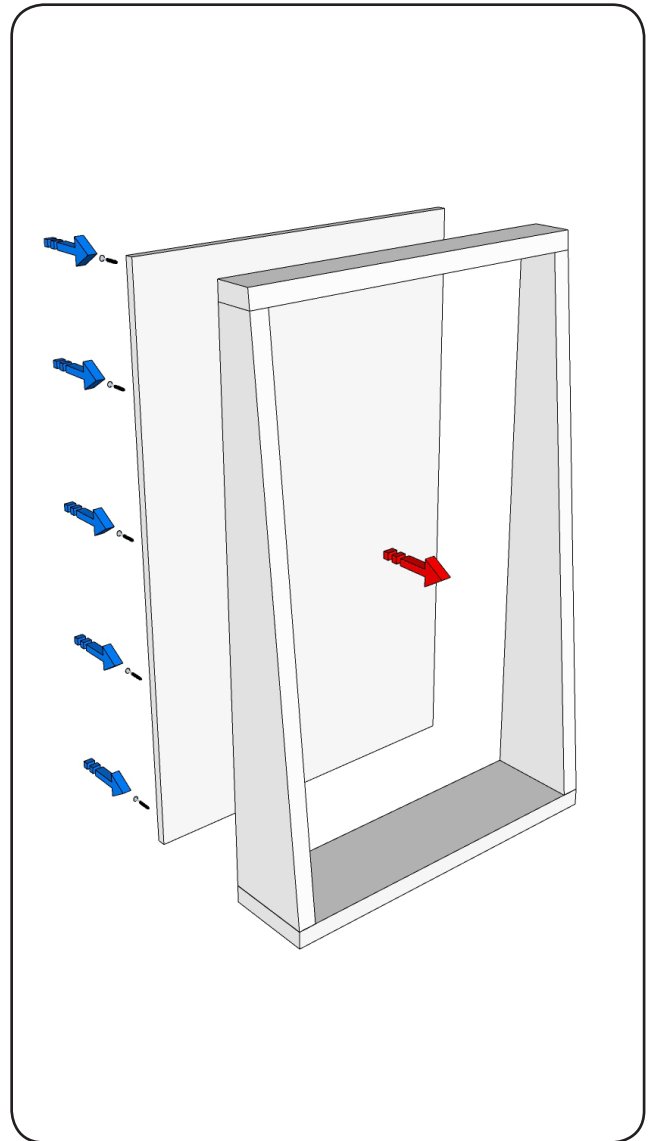

## ASSEMBLY:

5

Measure the inside width of cabinet and use that measurement for the width of the shelves.

To calculate the shelf depth, measure the depth of the cabinet at the desired placement of the shelf and subtract  $\frac{3}{4}$ ". This will ensure the front of the shelf is flush with the tapered edge of the cabinet sides once the face trim is attached.

Cut the desired number of shelves from  $\frac{3}{4}$ " plywood.

Apply glue to back and sides of each shelf and screw from back and sides with 2-1/2" screws.

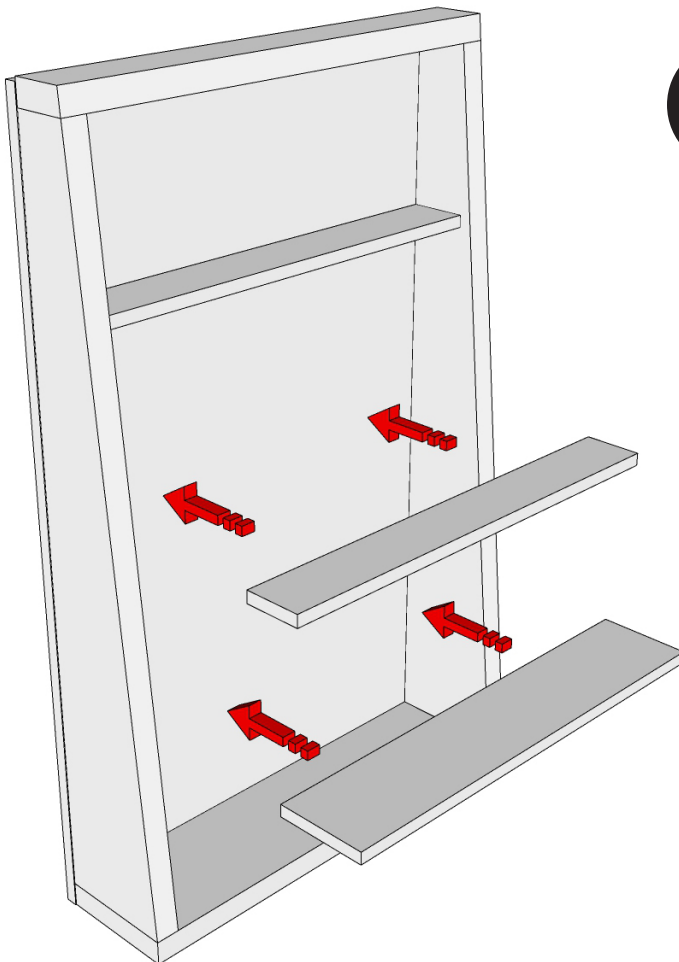

### HELPFUL HINT

For more customized organization, consider drilling holes into bottom shelf to keep small hand tools, such as screwdrivers and chisels, organized and within easy reach.

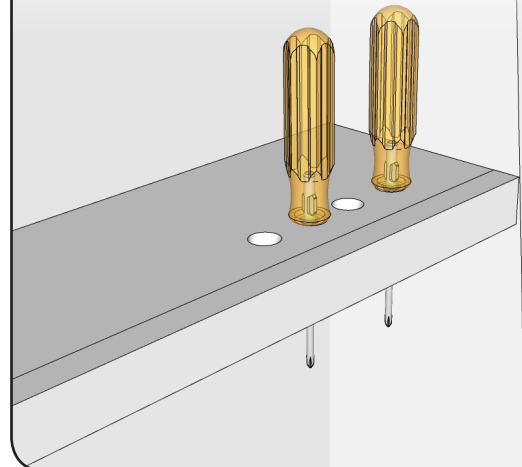

## ASSEMBLY:

6

From 1x2" boards, cut the face trim for each shelf. Apply glue front of each shelf and attach using 1-1/4" brad nails.

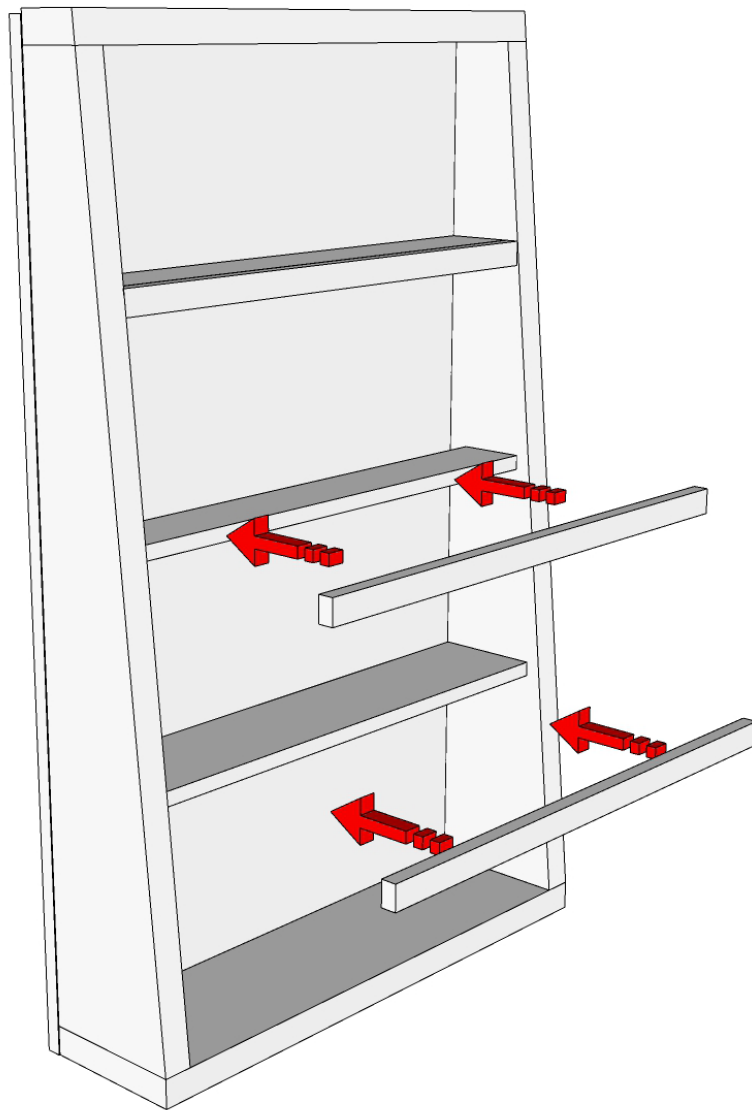

## ASSEMBLY:

7

To construct work table, start by squaring off the edges of 2x4 boards and cut a rabbet groove  $\frac{3}{4}$ " wide and  $\frac{3}{4}$ " deep along the entire length of the boards. This rabbet will accept the plywood table top.

Outer edge of frame

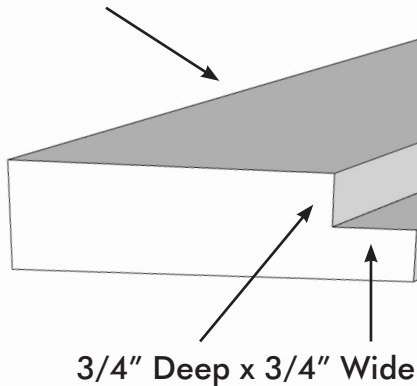

### HELPFUL HINT

When using a router to make rabbet cut, make multiple passes, lowering the depth of each cut until the final depth is achieved. Use a small piece of plywood to test the depth of the rabbet to make sure it sits flush within the frame.

8

Next, trim out the table top like a picture frame. Using a miter saw set to  $45^\circ$ , cut two boards 48" long and two boards 30" long.

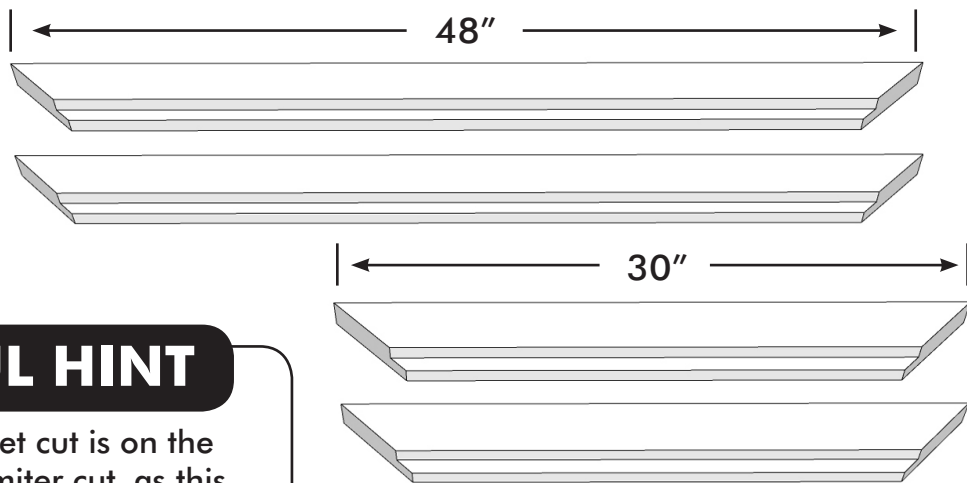

### HELPFUL HINT

Make sure the rabbet cut is on the shorter side of the miter cut, as this will be the inside of the frame.



## ASSEMBLY:

9

Lay out each side of the table frame. Drill pilot holes through the sides of the frame. Apply glue to miter cuts and fasten the frame together using 3-1/2" screws.

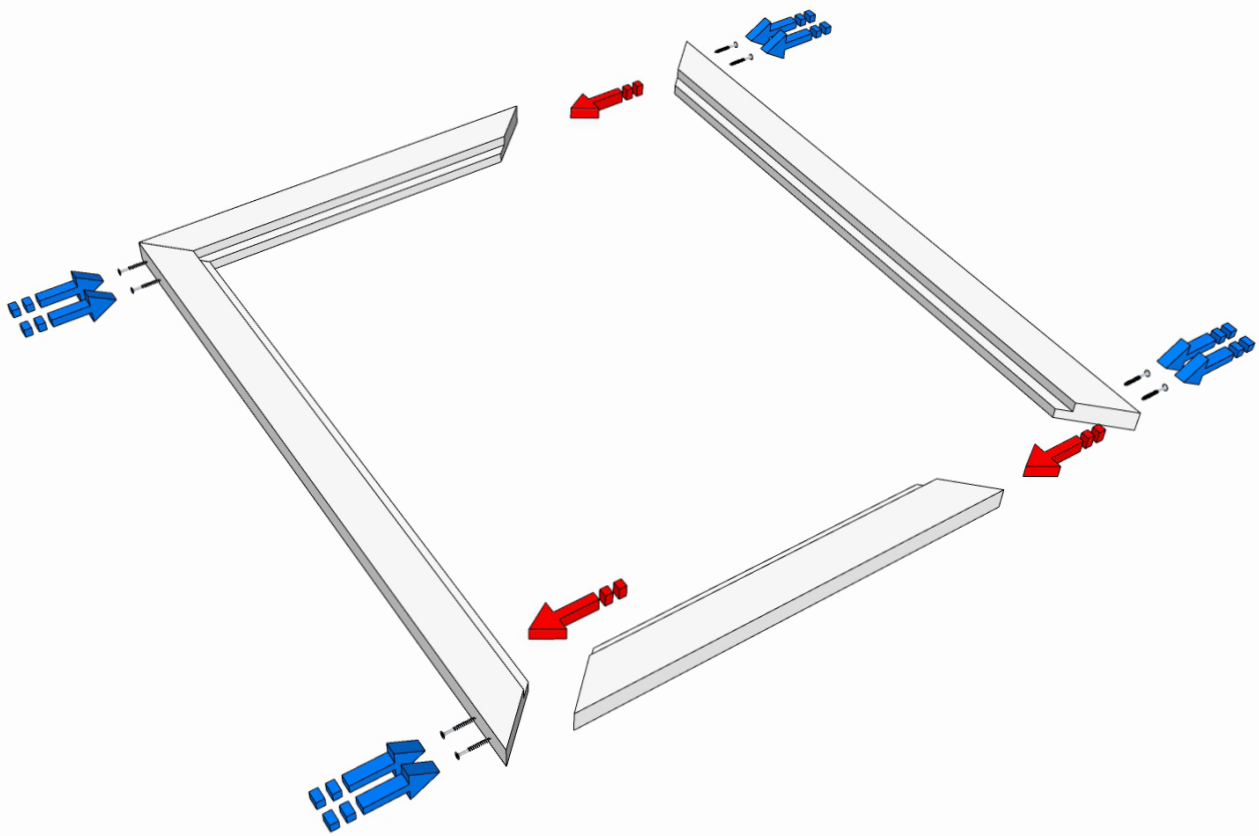

## ASSEMBLY:

**10**

Measure the length and width from the outer edge of rabbet cut in the frame and use that measurement to cut table top from 3/4" plywood.

Apply glue inside rabbet cut. Table top should fit flush inside the frame.

Fasten to frame using 1-1/4" brad nails.

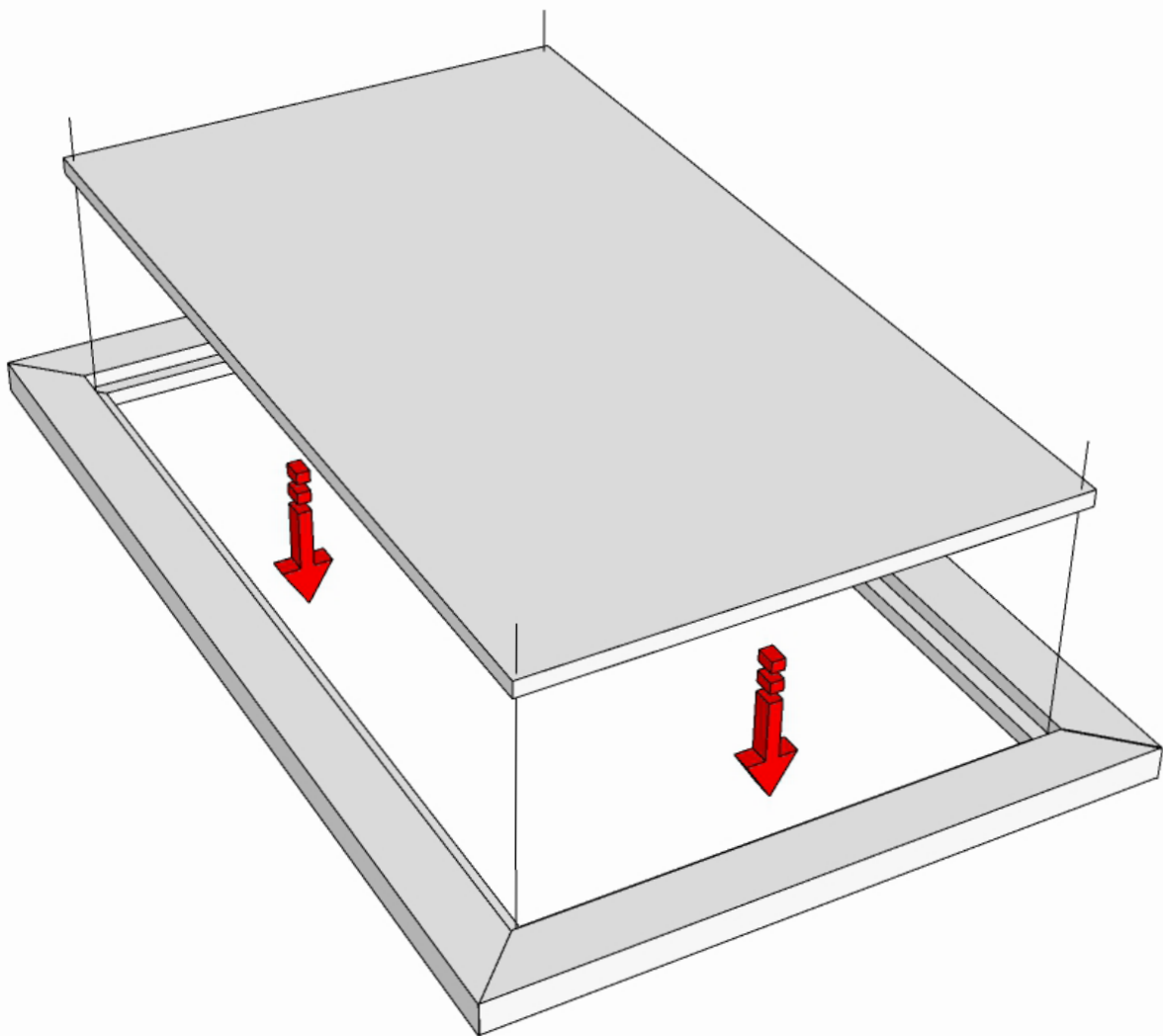

## ASSEMBLY:

11

To construct table leg, start by squaring off the edges of 2x4 boards and cut a rabbet groove  $\frac{3}{4}$ " wide and  $\frac{3}{4}$ " deep along the entire length of the boards. This rabbet will accept the plywood inlay.

Outer edge of frame

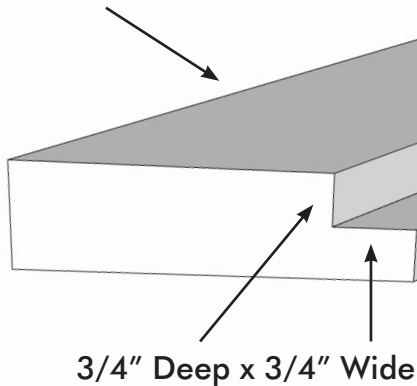

### HELPFUL HINT

When using a router to make rabbet cut, make multiple passes, lowering the depth of each cut until the final depth is achieved. Use a small piece of plywood to test the depth of the rabbet to make sure it sits flush within the frame.

12

Next, trim out the table leg like a picture frame. Using a miter saw set to  $45^\circ$ , cut two boards  $34\frac{1}{4}$ " long and two boards 30" long.

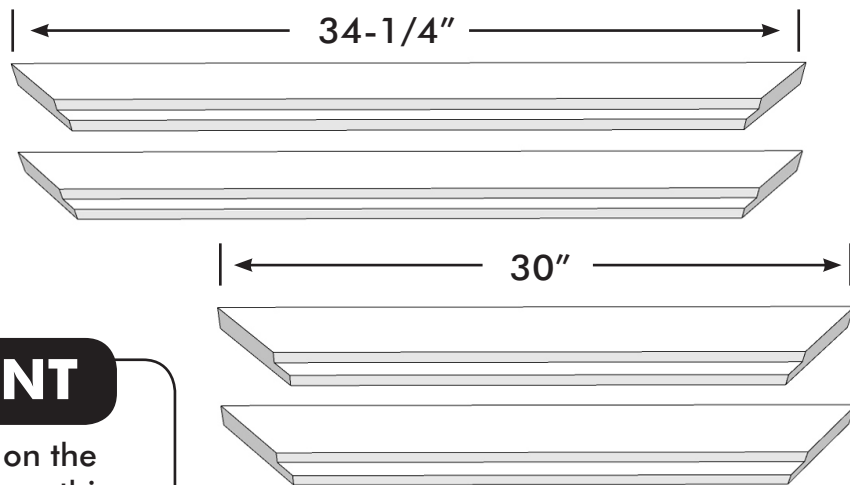

### HELPFUL HINT

Make sure the rabbet cut is on the shorter side of the miter cut, as this will be the inside of the frame.

## ASSEMBLY:

13

Layout each side of the leg frame. Drill pilot holes through the sides of the frame. Apply glue to miter cuts and fasten the frame together using 3-1/2" screws.

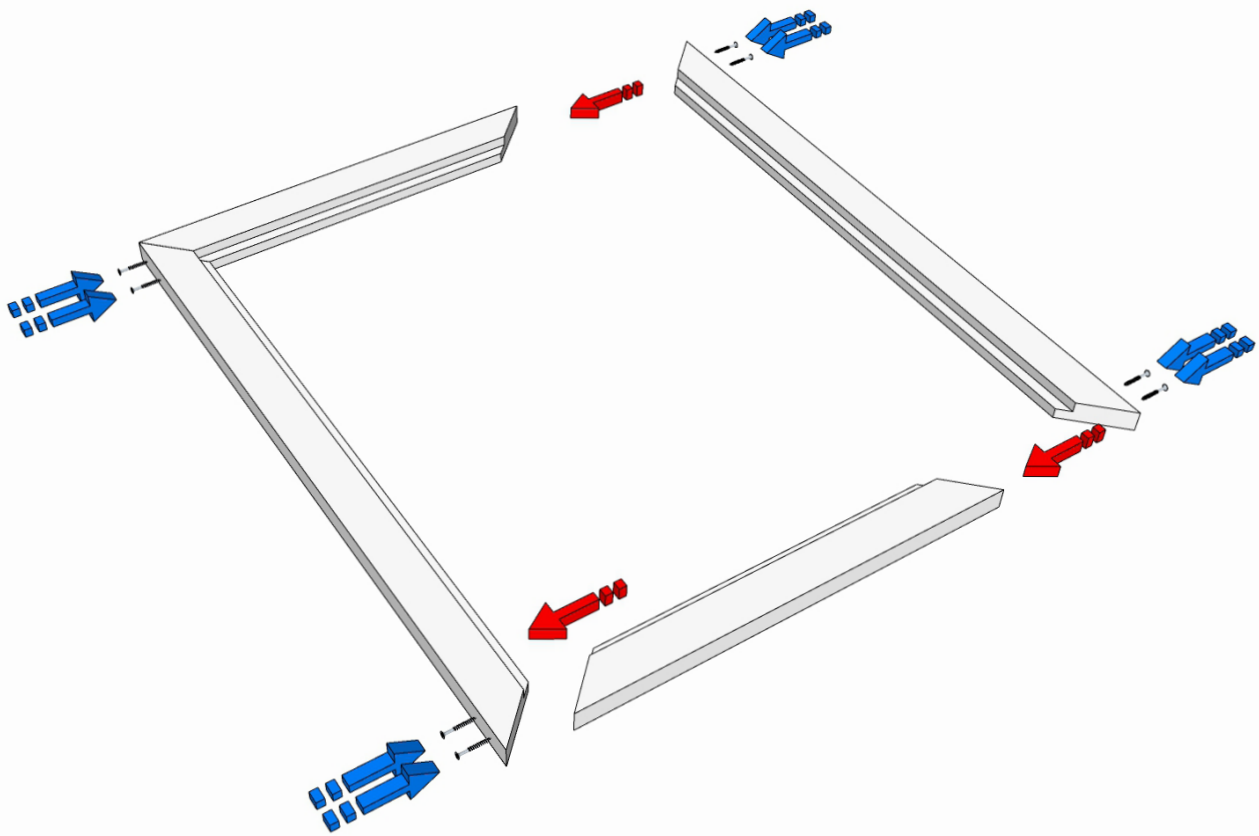

## ASSEMBLY:

14

Measure the length and width from the outer edge of rabbet cut in the frame and use that measurement to cut the leg inset from 3/4" plywood.

Apply glue inside rabbet cut. Leg inset should fit flush inside the frame.

Fasten to frame using 1-1/4" brad nails.



### HELPFUL HINT

Paint the side of the plywood that faces out with chalkboard paint before assembly.

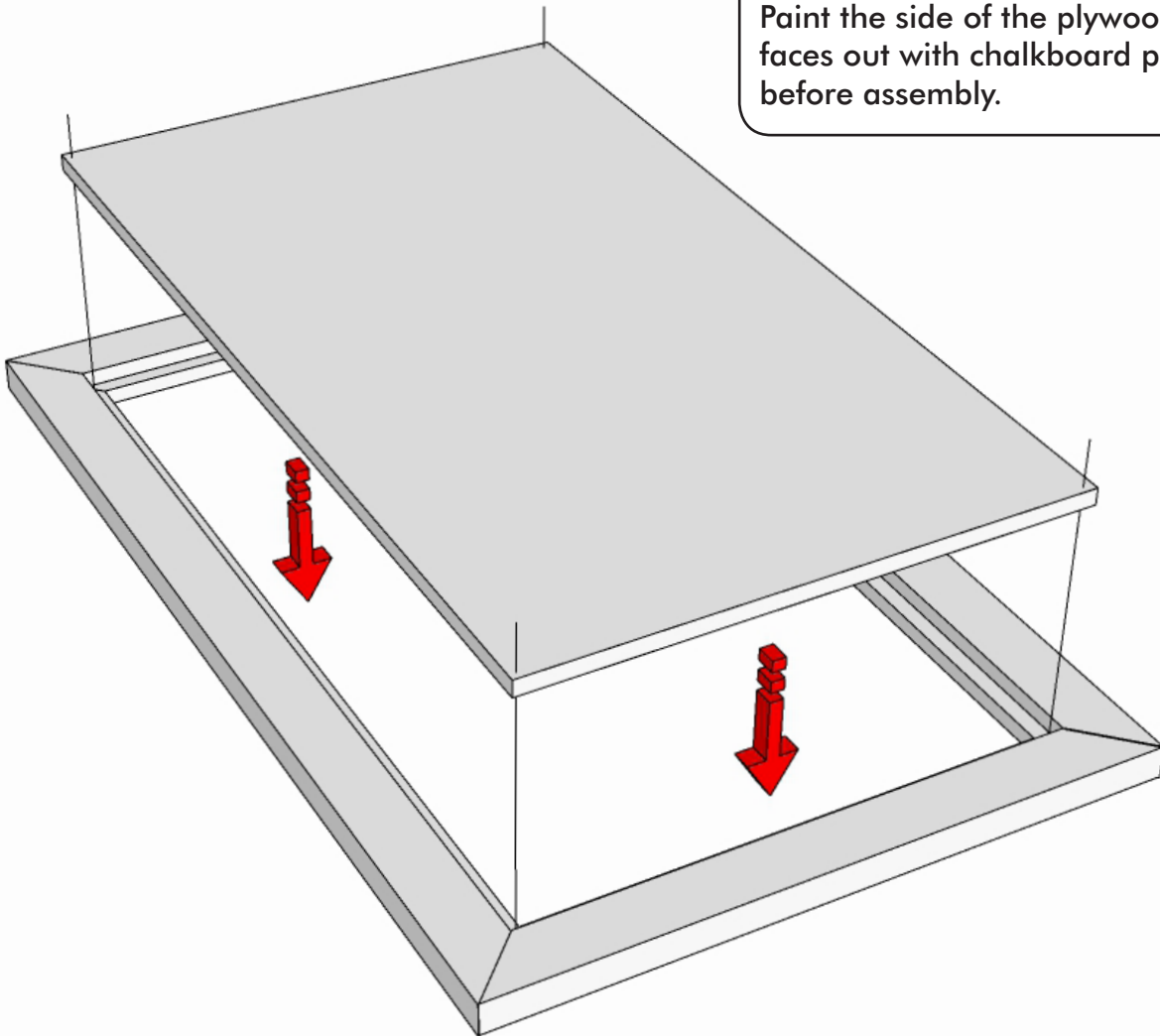

## ASSEMBLY:

15

Attach table to cabinet with piano hinge as instructed by the manufacturer.

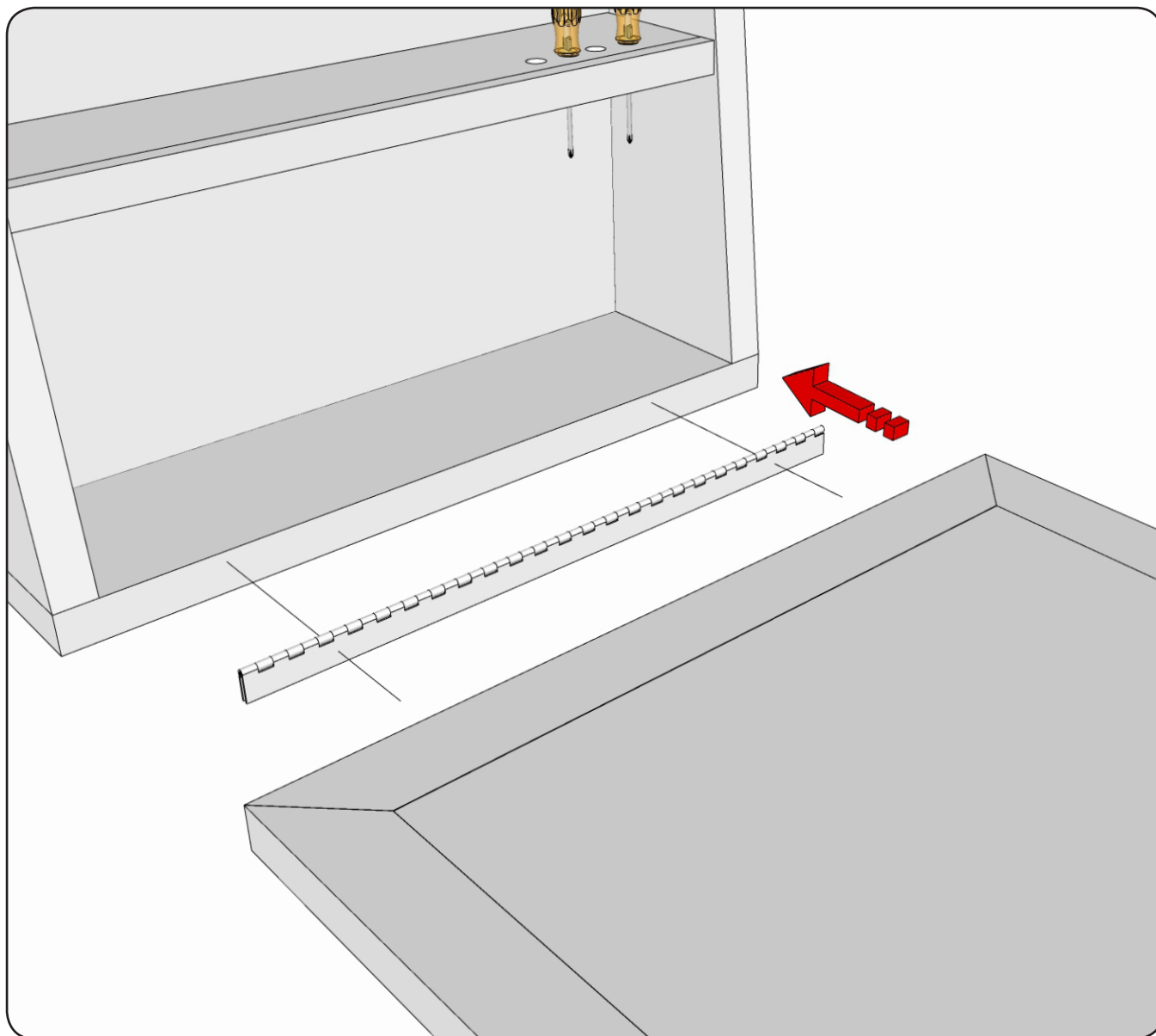

## ASSEMBLY:

16

Attach leg to table leg to the table with piano hinge and both right and left lid support hinge as instructed by the manufacturer.

Attach pull handle to bottom of leg.

Attach rubber surface pad to bottom of table leg.

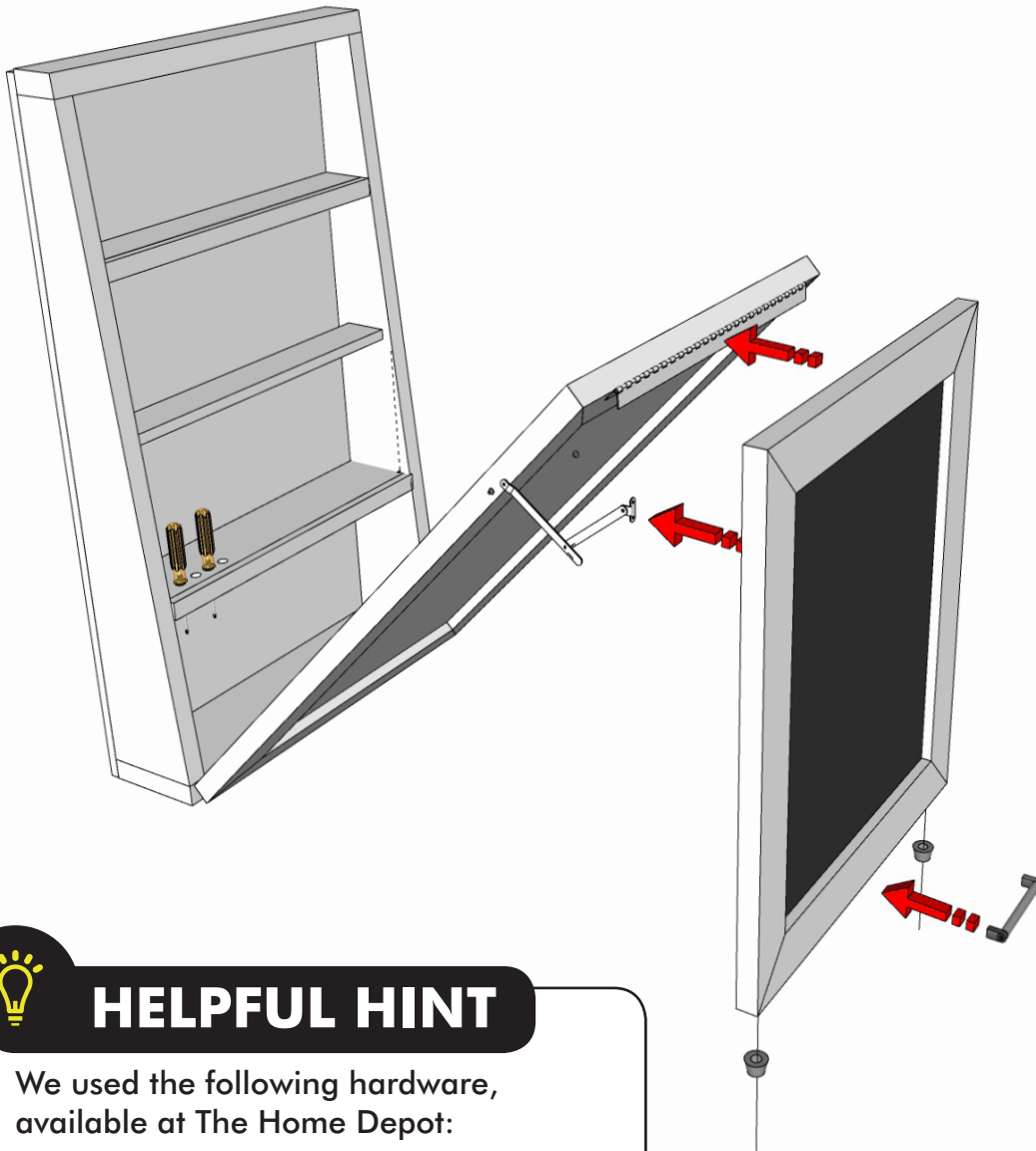

### HELPFUL HINT

We used the following hardware, available at The Home Depot:

- Left Lid Hinge: sku# 1000020965
- Right Lid Hinge: sku# 1000020966
- Pull Handle: sku# 1001810352
- Rubber Pad: sku# 101032

## ASSEMBLY:

17

For safety, install 6" black hook and eye latch, or other hardware to lock the table to the cabinet.

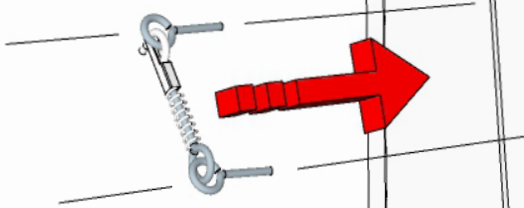

### HELPFUL HINT

We used the following hardware, available at The Home Depot:

- Hook and Eye Latch : sku# 568863



## ASSEMBLY:

18

Locate studs in wall and hang completed cabinet to the wall by driving (6) 2-7/8" Headlok screws through the back of the cabinet into the wall's studs.

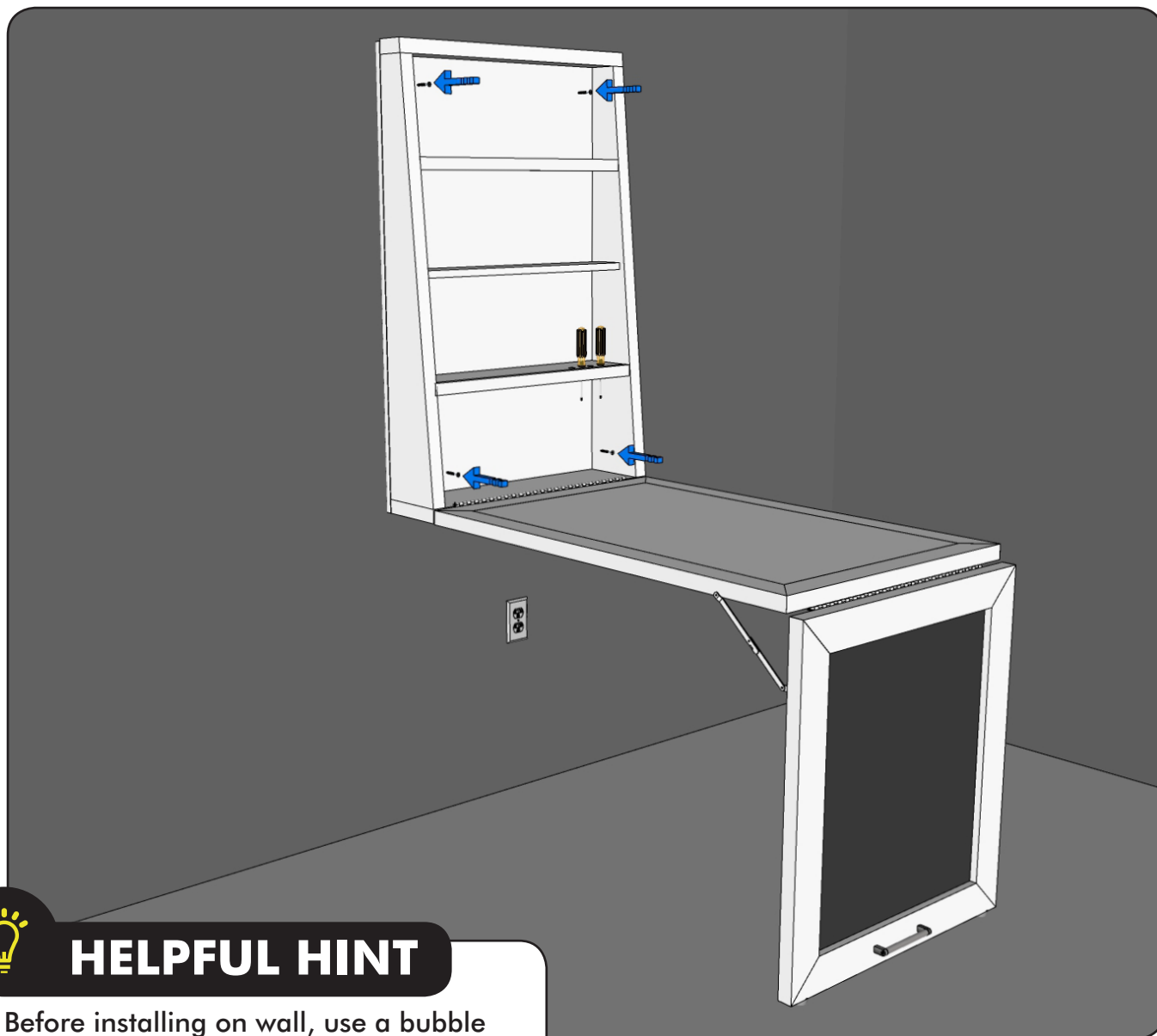

### HELPFUL HINT

Before installing on wall, use a bubble level placed on the table surface to make sure the table will level once installed.