

CONCEALED BAR CONSOLE TABLE



DIMENSIONS: 48" X 37½" X 24" (CLOSED. 96"W OPEN)
DIFFICULTY LEVEL: ADVANCED

TOOLS

REQUIRED

Circular Saw and/or
Jig Saw
Miter Saw
Drill/Driver

OPTIONAL

Brad Nailer
Table Saw

ADDITIONAL REQUIRED ITEMS

Tape Measure
Pencil
Safety Glasses
Hearing Protection

PURCHASE LIST:

(2) 3/4" x 4' x 8' Hardwood Plywood
(1) 1" x 2" x 8' Board
(6) 3" Casters
(4) 30" Continuous Hinge
Cabinet Knob/Pull (optional)
1 1/4" Washer Head Screws
1 1/4" Wood Screws (if not using Brad Nailer)
1 1/4" Brad Nails (optional)
Wood Glue

LUMBER CUT LIST:

3/4" X 4' X 8' HARDWOOD PLYWOOD

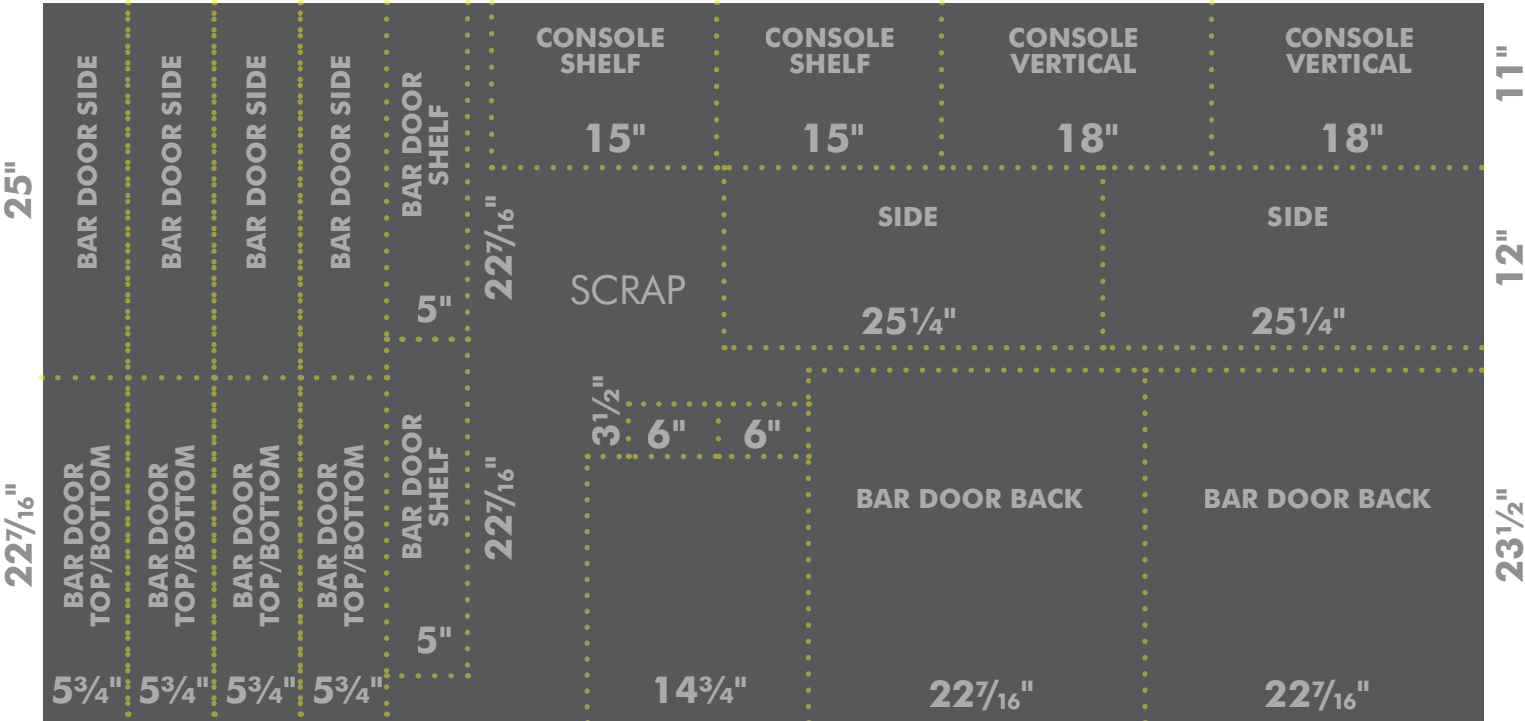
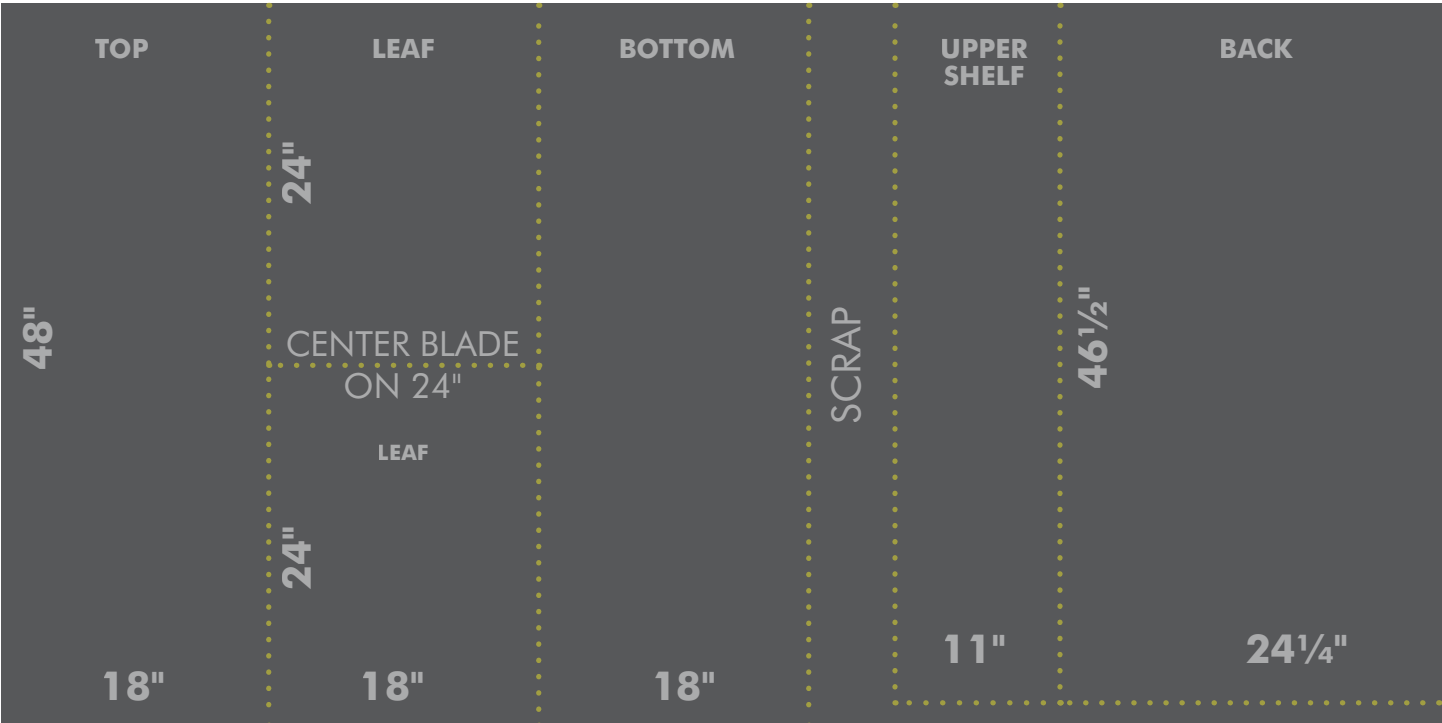

1" X 2" X 8'



ASSEMBLY:

1

ASSEMBLE BASE

Layout a natural curve (same on both sides). Then, using a jigsaw cut out bottom as shown.

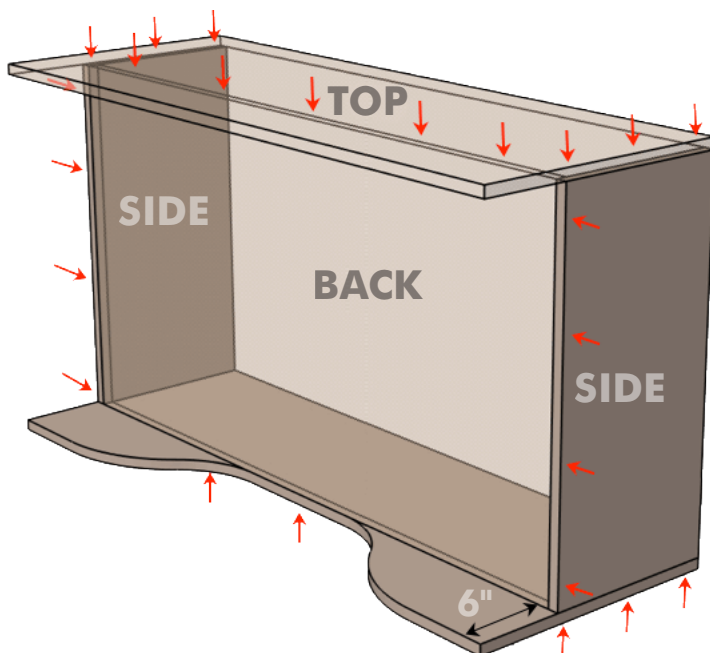
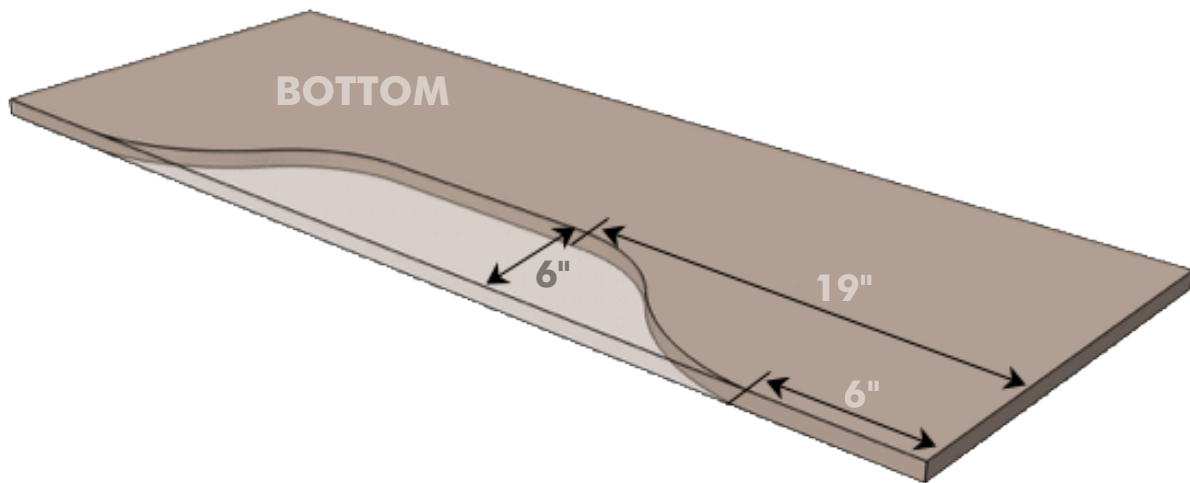

Assemble the base as shown using wood glue and 1 1/4" screws (pre-drill holes using 7/64" drill bit) or use **brad nails** (not all shown).



HELPFUL HINT

Prior to assembly, any exposed plywood edges should be edge banded. Also consider your finish and how to work that into the assembly most efficiently.

2

INSTALL CONSOLE

Start by attaching the upper shelf and vertical panels using wood glue and 1 1/4" screws (pre-drill holes using 7/64" drill bit) or use **brad nails**.

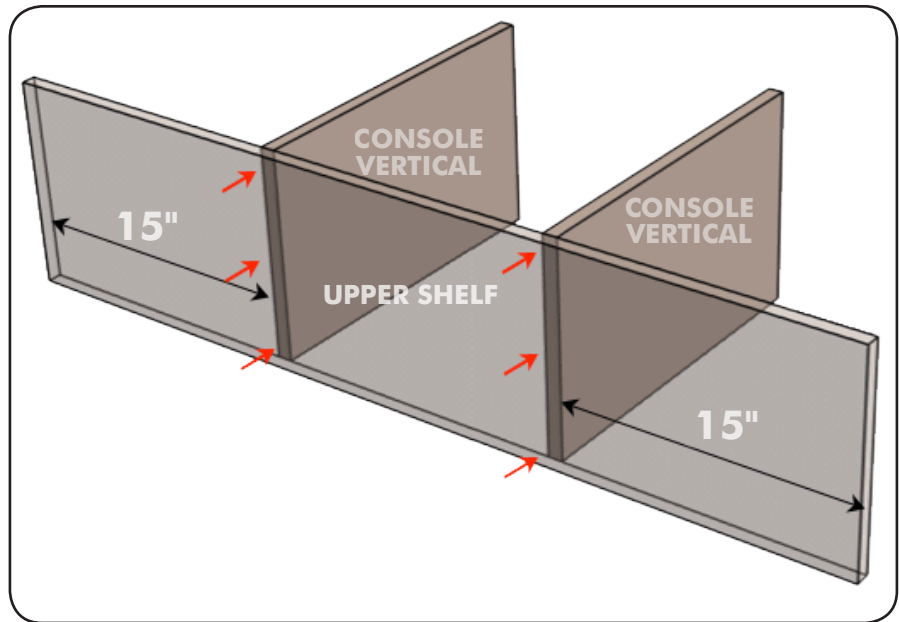

Apply wood glue and place upper shelf and verticals, check square and secure with 1 1/4" screws (pre-drill holes using 7/64" drill bit) or use **brad nails**. Then, install shelves with wood glue and 1 1/4" screws or brad nails.

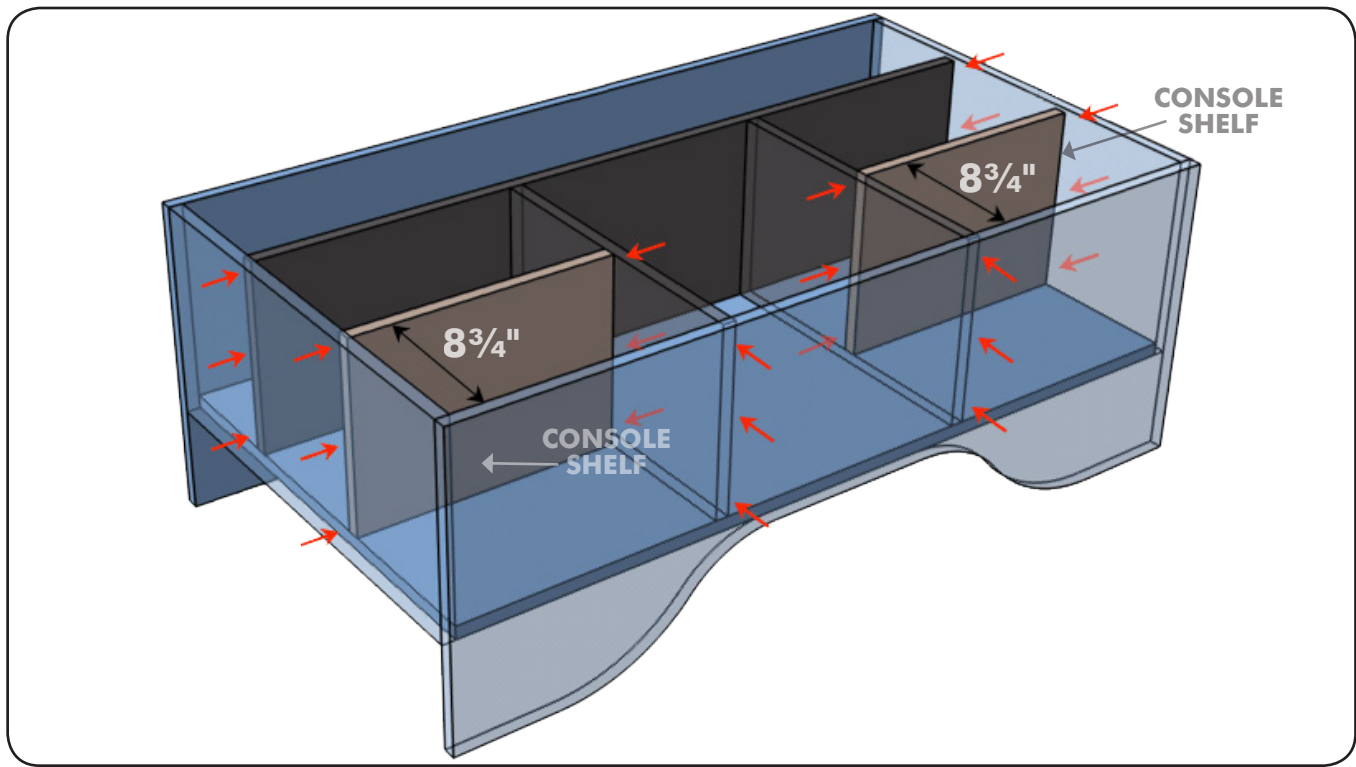

3

INSTALL CASTERS AND DOOR

Trim door as required to fit, edge band, install knob or drill hole and install using desired hinges.

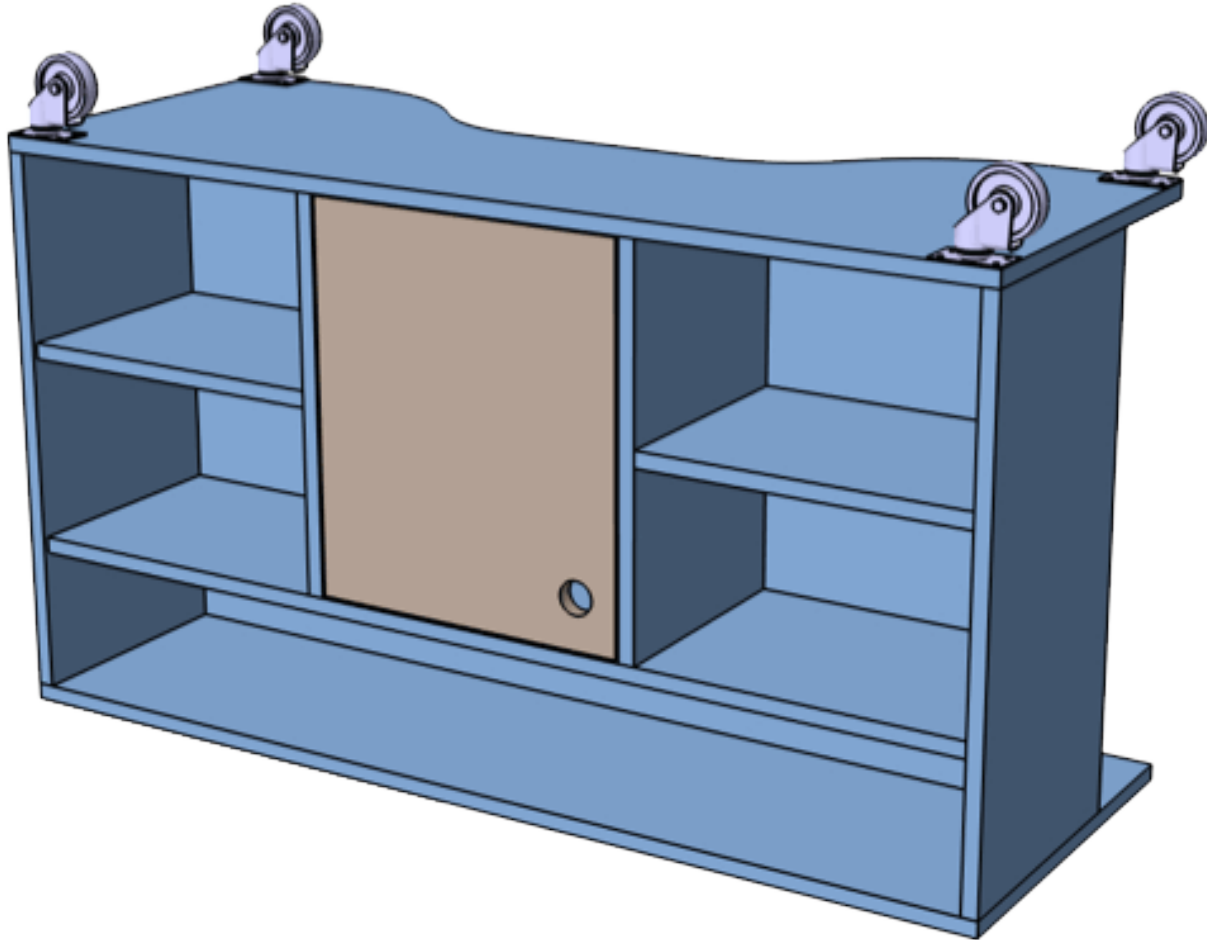

4

ASSEMBLE BAR DOOR #1

Assemble the door as shown using wood glue and 1 1/4" screws (pre-drill holes using 7/64" drill bit) or use **brad nails** (not all shown).

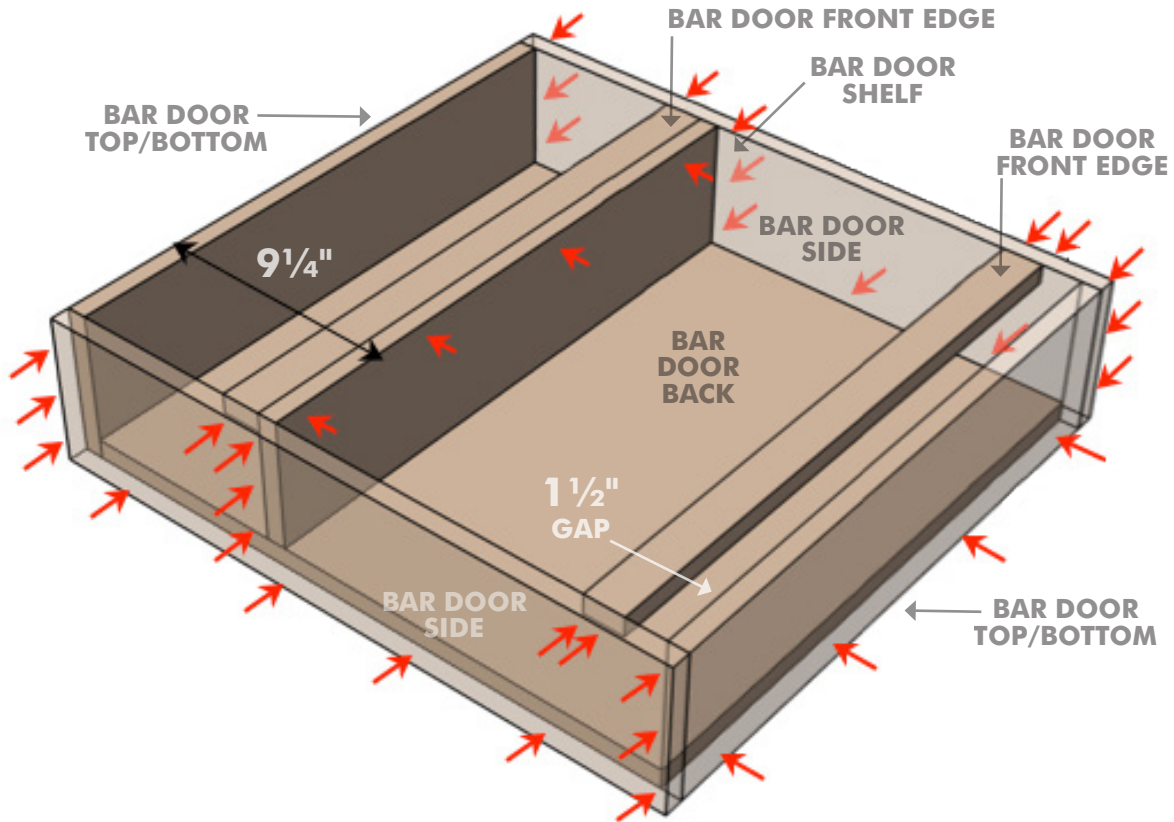

5

ASSEMBLE BAR DOOR #2

Assemble the door as shown using wood glue and 1 1/4" screws (pre-drill holes using 7/64" drill bit) or use **brad nails** (not all shown).

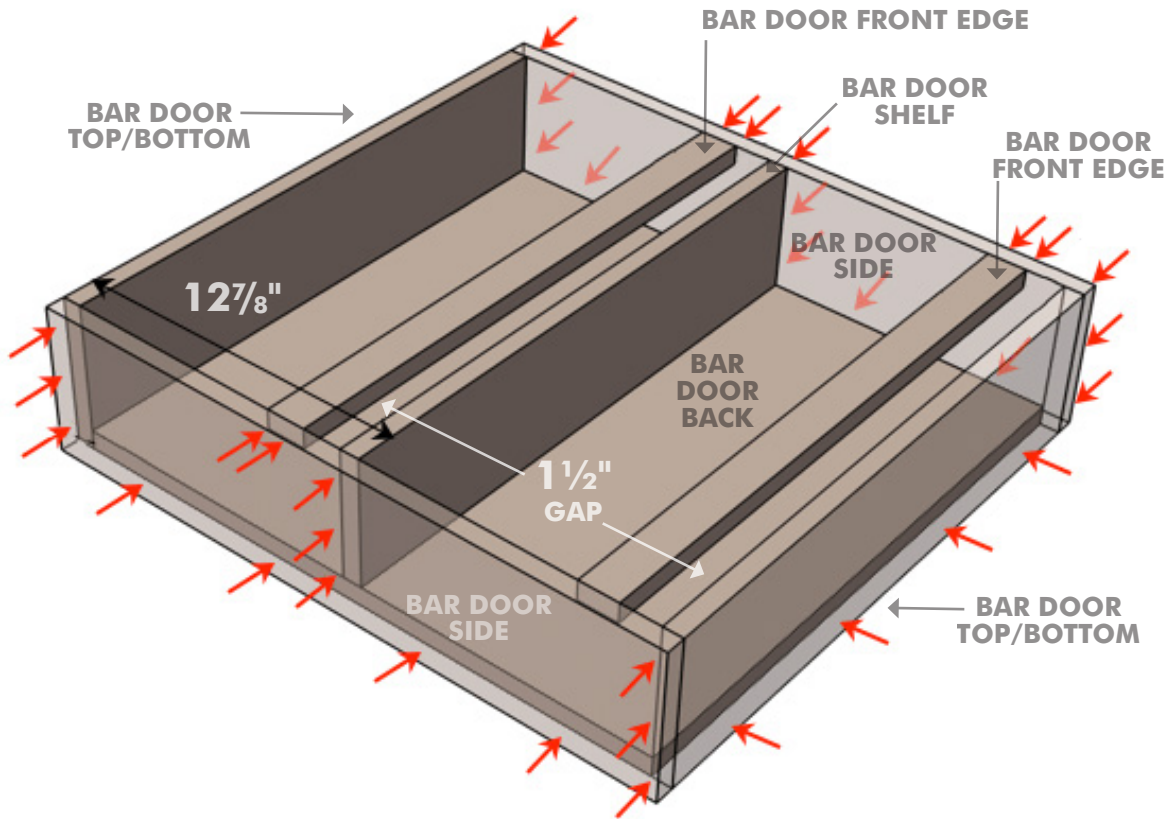

6

ATTACH DOOR CASTERS

Secure 3½" x 6" spacers using wood glue and 1¼" screws (pre-drill holes using 7/64" drill bit) or use brad nails. Then, install casters using 1¼" washer head screws.

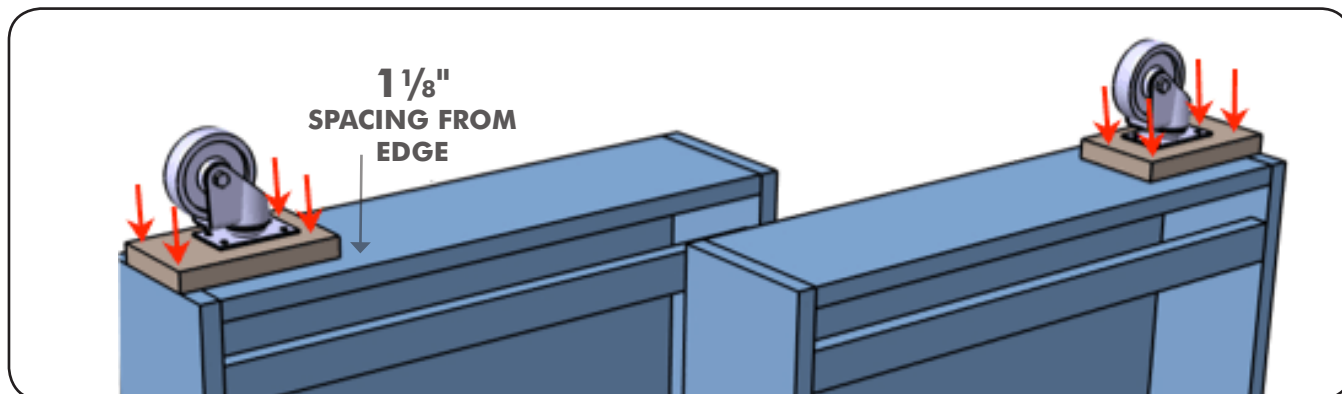

7

INSTALL BAR DOORS

Cut continuous hinges to 25". Shim doors to correct height, then pre-drill and install hinges with included hardware.

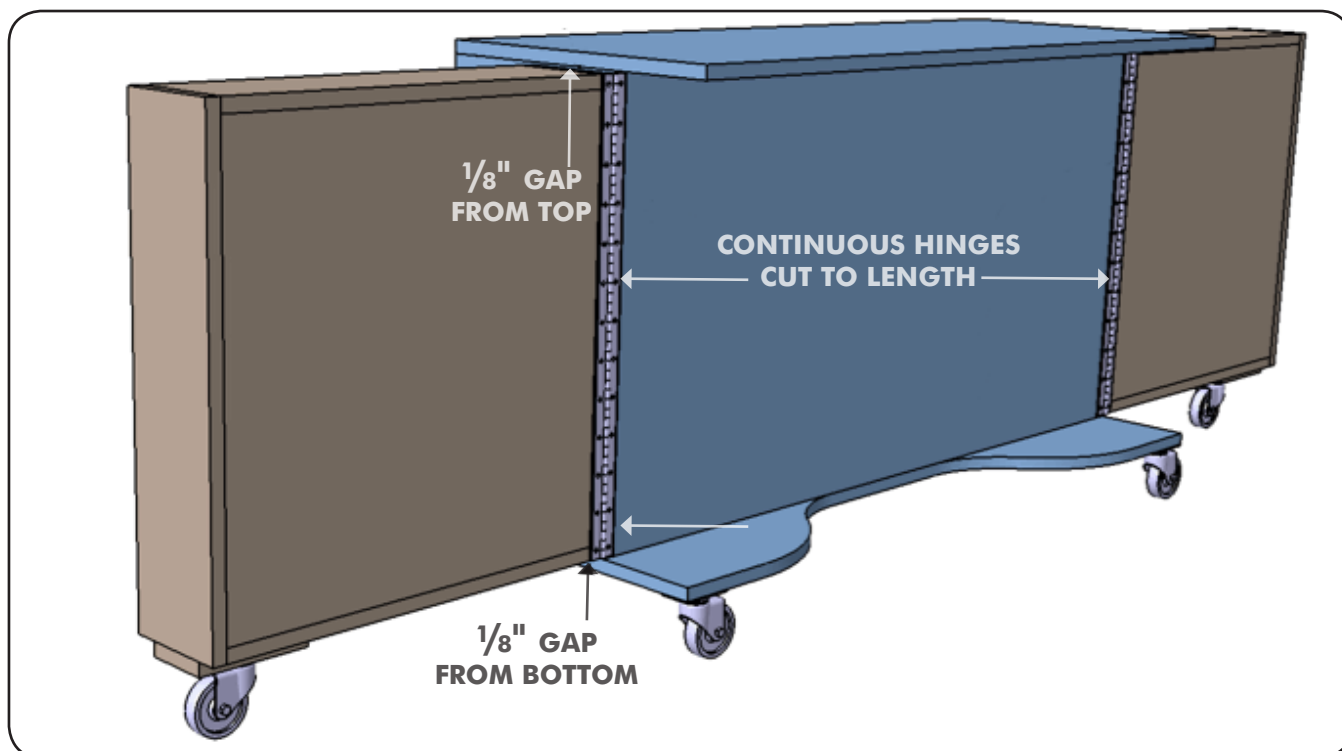

8

INSTALL LEAFS

Cut continuous hinges to 18". Pre-drill and install hinges with included hardware. Then add 1/8" thick **bumpers** to allow correct spacing when closed.

