

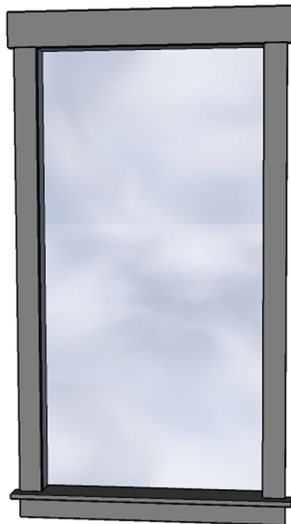

©2016 WWW.SHANTY-2-CHIC.COM



DIY WINDOW TRIM



SUPPLY LIST

Item	Quantity	Description
1x6x8	1	select pine or MDF
1x4x8	3	select pine or MDF
2 1/2" finish nails		
construction adhesive		

Remember!

Many of these cuts are best made as you go. If you have questions, check out the tutorial on our site!



CUT LIST

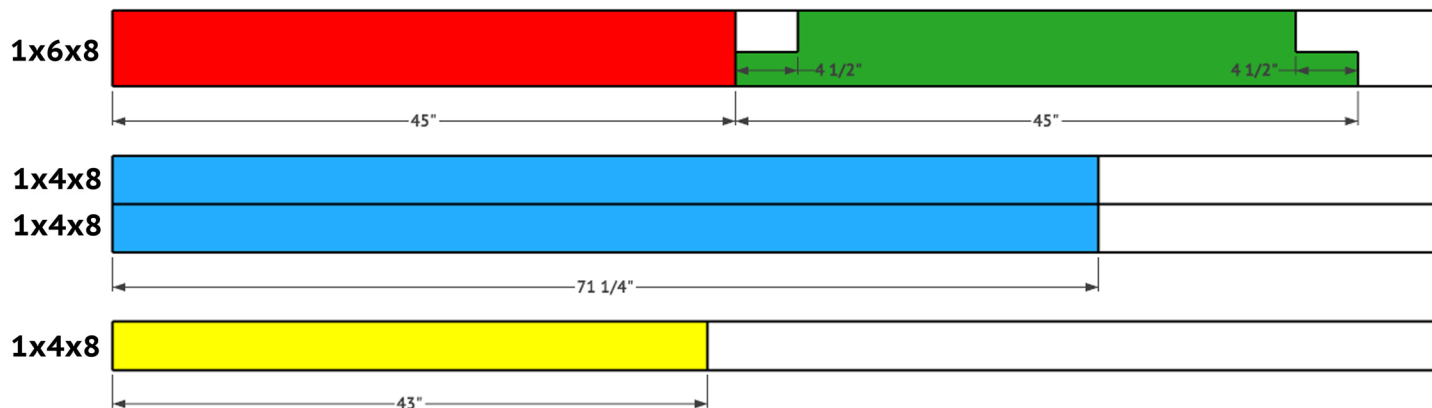

Based on a 36"x72" window. Measure and cut as you go.

1

Measure the bottom of the window for your sill and add 9" to get the length for the windowsill piece. Use a jigsaw and a speed square to cut notches out of the top corners. Measure the width of the window frame to get the measurement for the other cut. My window frame is 3" so my notches are 4 1/2"x3".

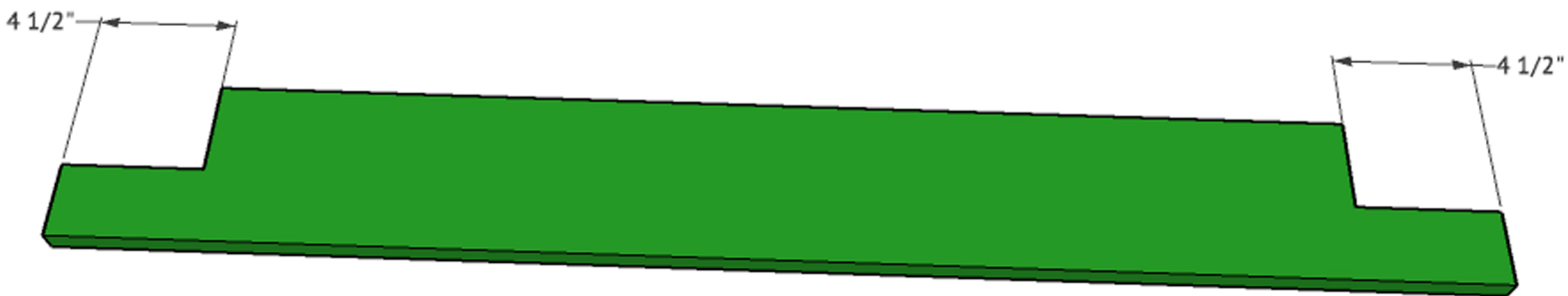

2

Attach the windowsill to the window frame with 2 1/2" finish nails and adhesive.

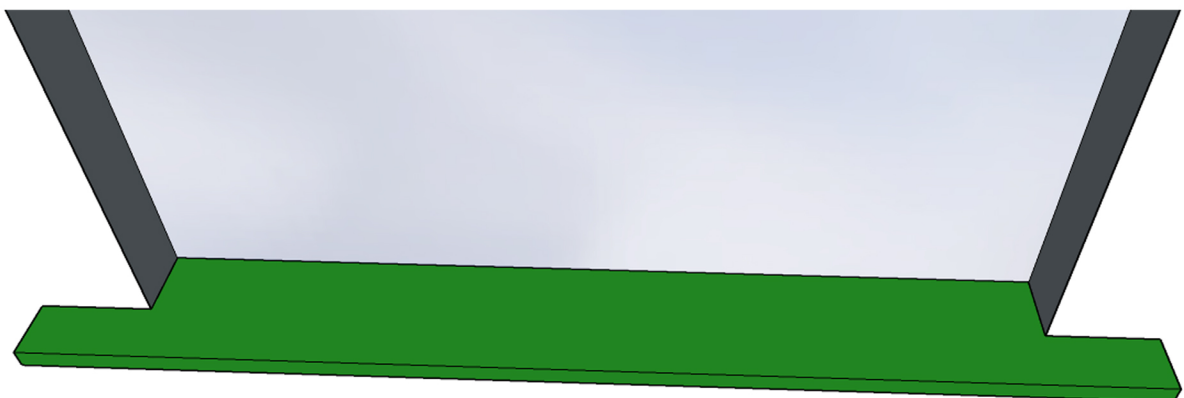

3

Now, measure from the top of the sill to the top of the window frame to get the measurement for the side trim pieces. Attach them with 2 1/2" finish nails and adhesive.

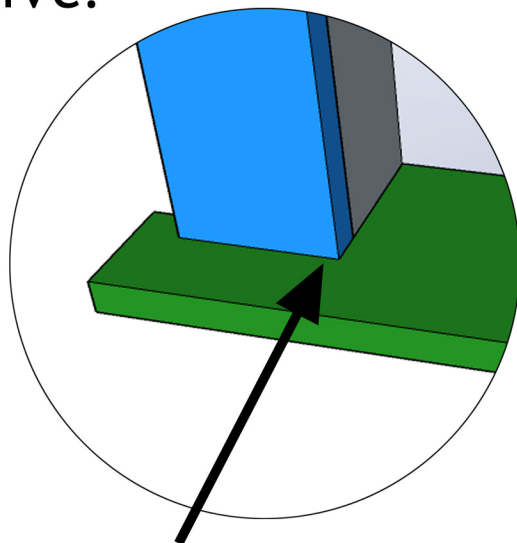
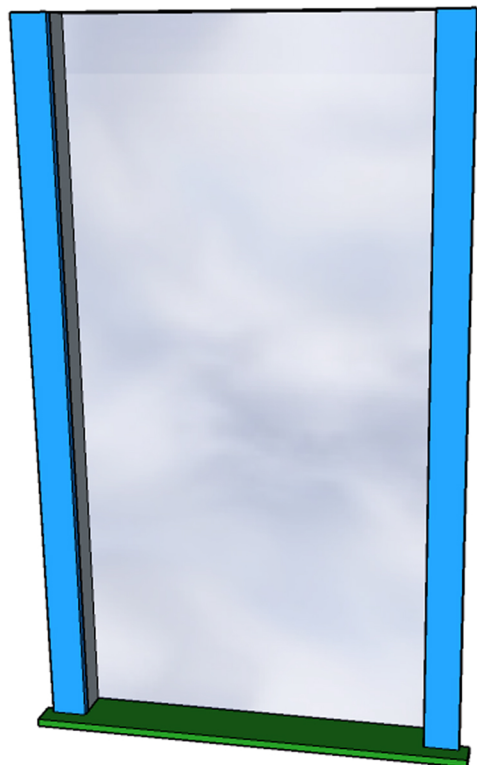

Trim flush with window frame.

4

Measure from the end of one side piece to the other and add 2" to get the length of the top trim piece. Attach with 2 1/2" finish nails and adhesive leaving a 1" overhang on both sides.

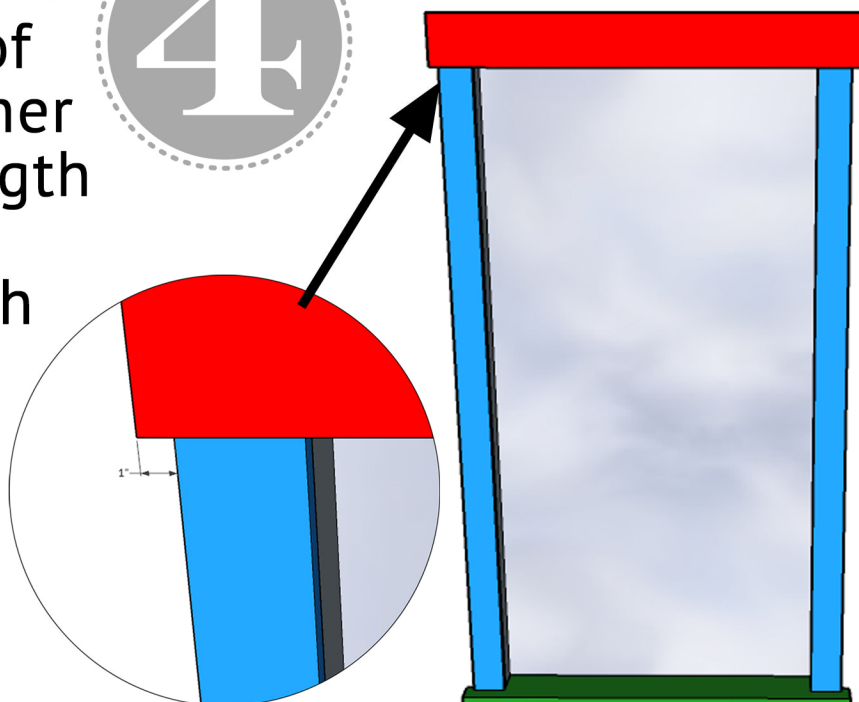

5

Measure from the edge of one side piece to the other and cut the bottom apron piece to that length. Attach with 2 1/2" finish nails and adhesive.

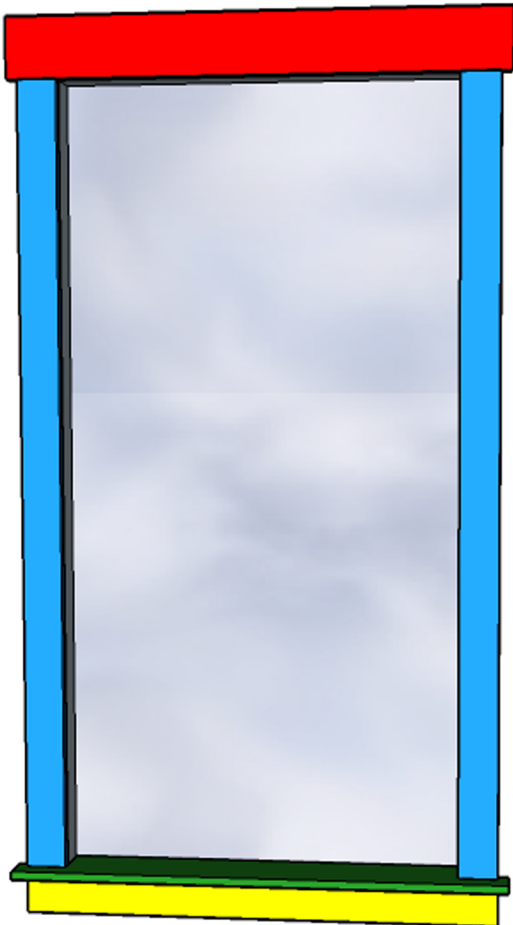

All finished! Be sure to send us pictures of your new builds or share them on social and use #shanty2chic so we can share them too!